

OMBRE BOMBSHELL

COLOR TECHNIQUE
Color Personality: AMALFI CHIC

Natural Level: 7 with pre-lightened ends

Texture: Average

Porosity: Normal

Formula **A**: TONES 7G mixed 1:2 with 7 Vol. Activator

Formula **B**: TONES 9G mixed 1:2 with 7 Vol. Activator



Step 1

Apply ColourPrime Pre-Color Treatment.



Step 2

Apply Formula A to the base and feather out 4" through mid-lengths.

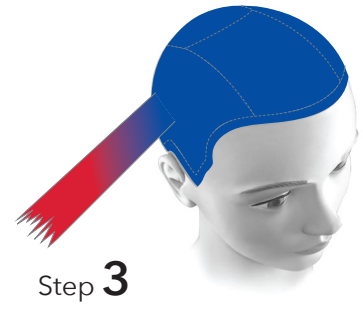

Step 3

Melt in Formula B through the mid-lengths to the ends.



Step 4

Develop, then rinse thoroughly and apply ColourLock Post-Color Finisher.



Step 5

Overlay InstaBoost Conditioning Color Masque in Copper Cabana mixed with Reparative Treatment Masque. Leave on for 5 minutes, then rinse thoroughly.